

# HEAVY DUTY CART



[WWW.FOREST-MASTER.COM](http://WWW.FOREST-MASTER.COM)

Garden & logging cart with adjustable sides



**IMPORTANT:** Read this manual fully before assembly and use and observe all safety rules and operating instructions



Technical Specification	2
Exploded Diagram	3
Parts List	4
Assembly	5
Operation as a Logging Cart	9
Safety	12
Warranty	13

Length (excluding tow handle)	900 mm	35 ins
Width (with vertical sides)	600 mm	24 ins
Bed depth (vertical sides)	270 mm	10.5 ins
Overall Height (vertical sides)	540 mm	21 ins
Height to bottom of bed	265 mm	10.5 ins
Maximum load	500 kg	1100 lbs
Towing handle length	750 mm	29.5 ins
Unladen weight	60 kg	132 lbs



WWW.FOREST-MASTER.COM

# Exploded Diagram

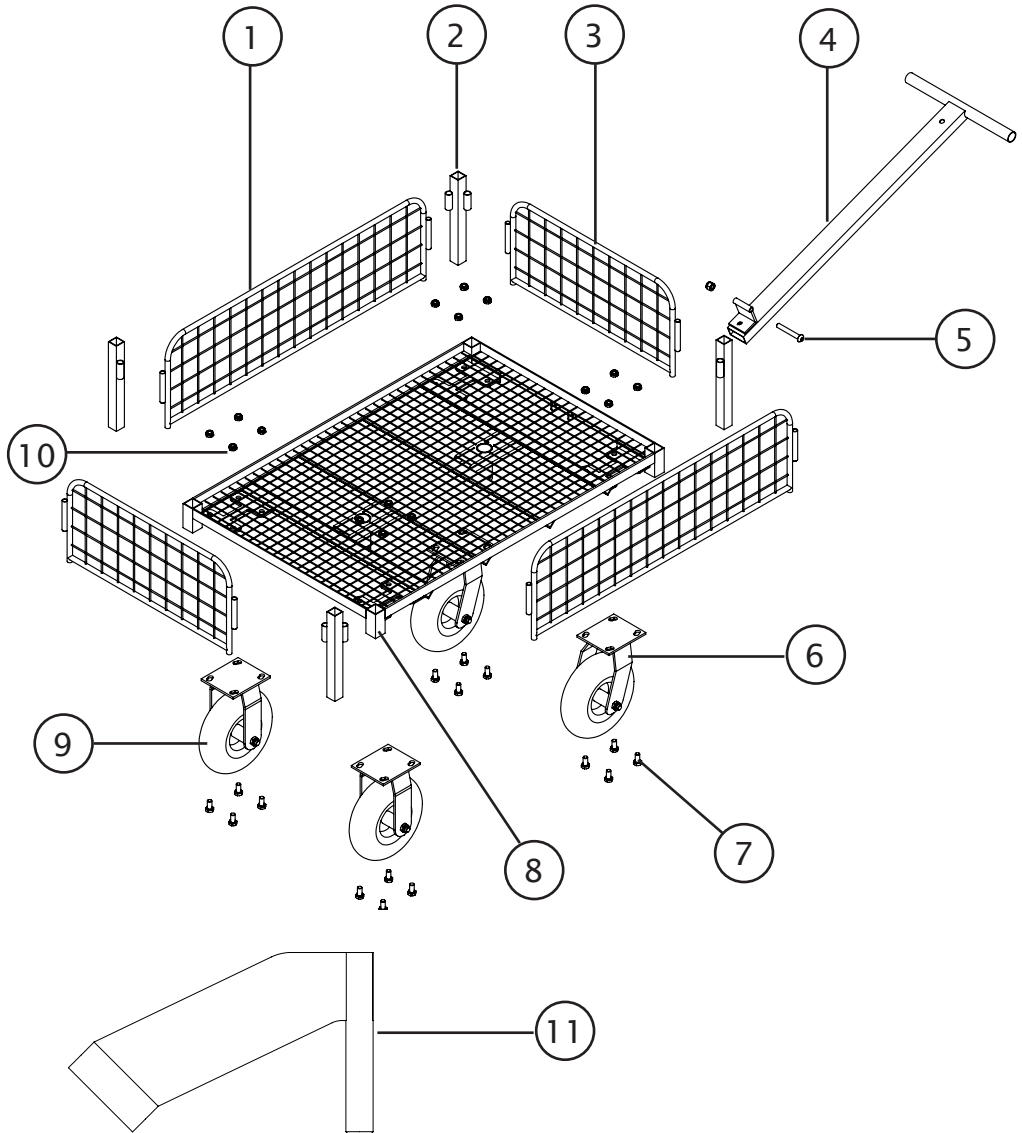



Item	Description	Qty
1	Side panel	2
2	Corner post	4
3	End panel	2
4	Tow handle	1
5	M10 x 70 mm socket button head bolt	1
6	Front castor wheel	2
7	M10 x 20 mm hex head bolt	16
8	Cart bed	1
9	Rear wheel	2
10	M10 nyloc nut	17
11	Angle bracket	8

## STEP 1:

Fix one of the front castor wheels (6) to the underside of the bed (8) at the front, using 4 M10 x 20 mm bolts (7) and 4 M10 nyloc nuts (10). Note that the nuts go between the bed and the fixing plate. The front of the bed has two tabs attached in the middle for connecting the tow handle.

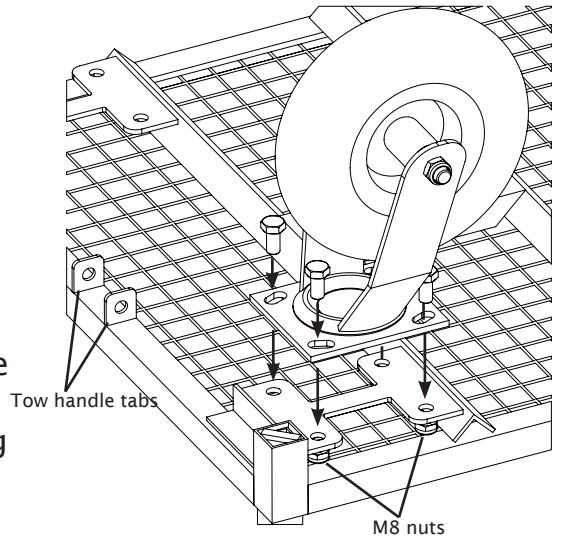

## STEP 2:

Attach the other front castor and the two fixed rear wheels in the same way.

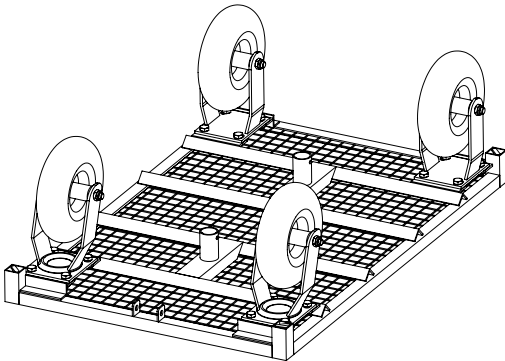

**NOTE:** The wheels can be attached either with the bed upside down on the ground or it can be raised on the four corner posts for a slightly more comfortable working height.



### STEP 3:

Attach the tow handle (4) between the two mounting tabs using the M10 x 70 bolt (5) and a M10 nyloc nut. The nut and bolt should be tightened sufficiently so that the handle will remain in the fully raised position but not enough to stop it raising and lowering.

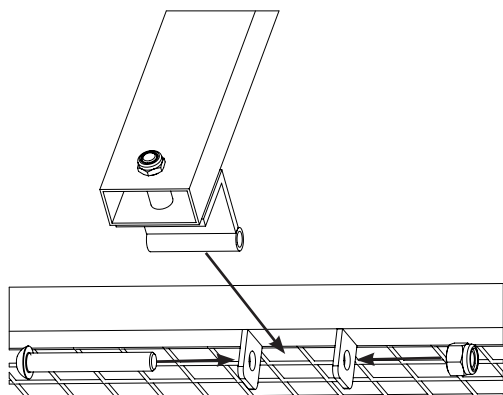

### STEP 4:

Insert one corner post (2) into each corner socket of the bed. The tubes for locating the side and end panels should be oriented to the inside of the post as shown.

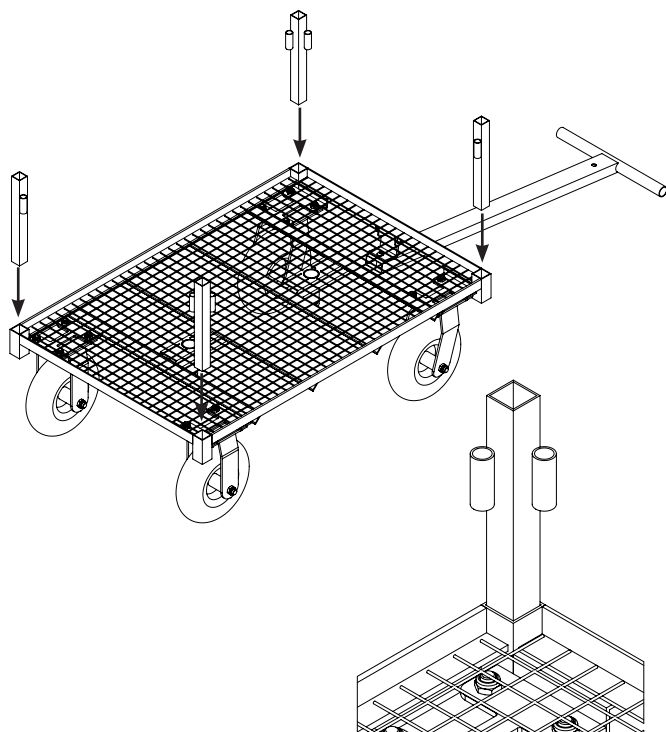

## STEP 5:

Attach the side panels (1) and end panels (3) by inserting the pins on the ends of the panels into the tubes on the corner posts.

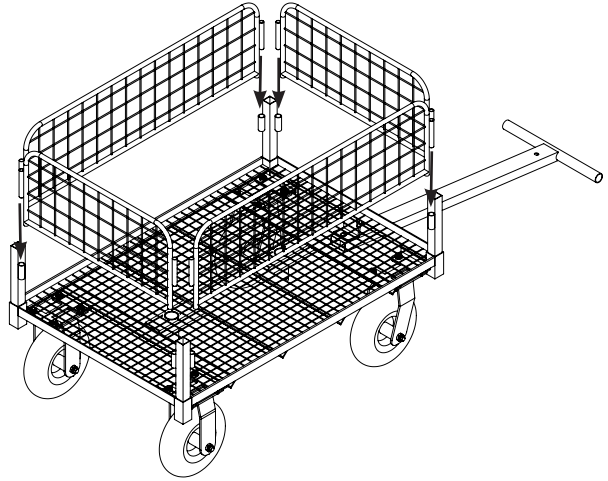

## Using The Cart With Sloped Sides

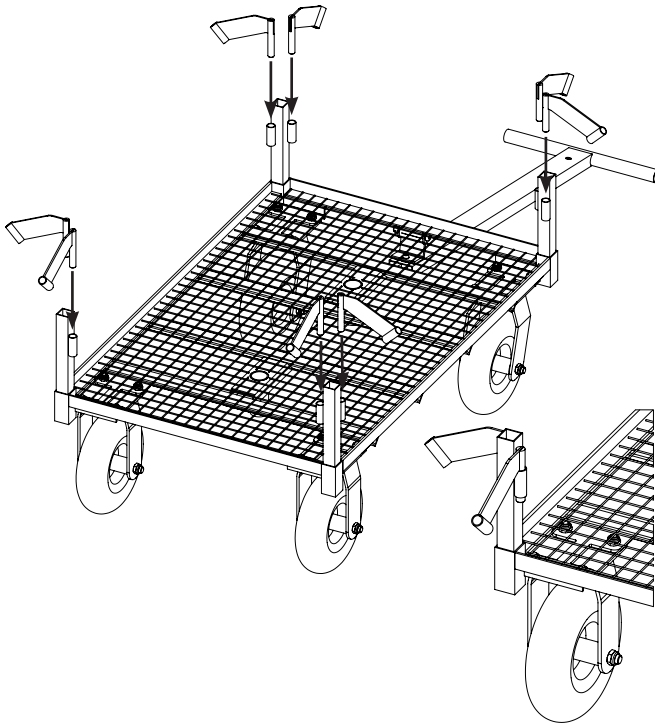

## STEP 1:

To use the cart with sloped sides, remove the side and end panels and insert the pins on the angle brackets (11) into the tubes on the corner posts. The angle brackets should be oriented so that the tubes for locating the panels are outward of the bed as shown.



## STEP 2:

Insert the pins on the ends of the panels into the tubes on the ends of the angle brackets.

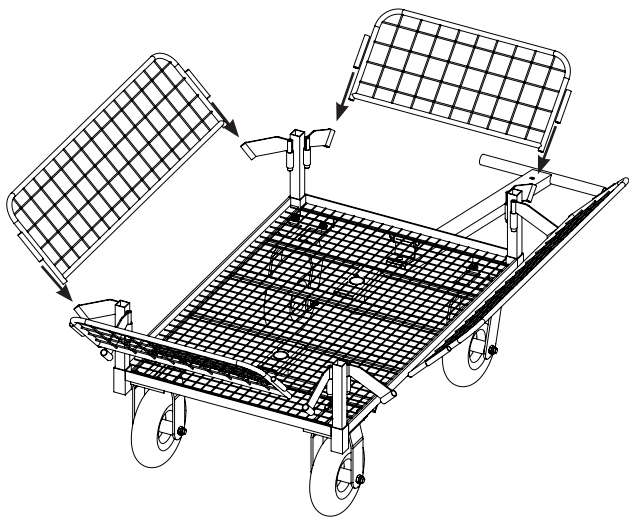



As well as being used as a garden cart, the Heavy Duty Cart can also be used as a logging cart with either the Bulk Log Stand 2, a pair of “U Sections” from either the Bulk Log Stand 2 or 4 or the Quick Fire Saw Horse.

## Quick Fire Saw Horse

To use the cart with the Quick Fire, simply put a log into the Quick Fire as normal then reverse the cart (with the sides in the sloped position) underneath the long overhanging end of the log.

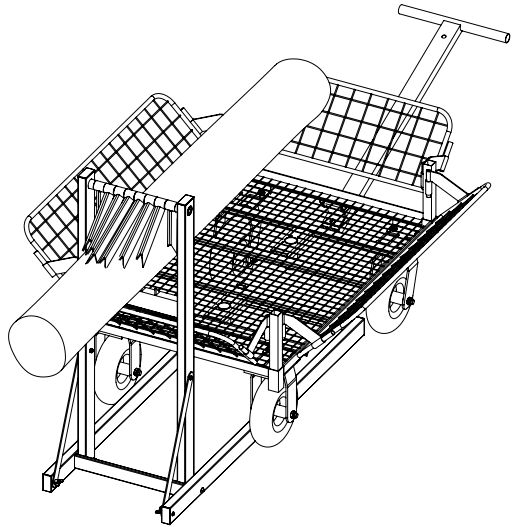

## Bulk Log Stand 2

The Bulk Log Stand 2 can be placed directly onto the bed of the cart. If the feet of the BLS2 are a tight fit against the sides of the cart then they can be angled slightly as shown or the plugs in the ends of the feet removed. Ensure the Bulk Log Stand is stable before cutting any logs.

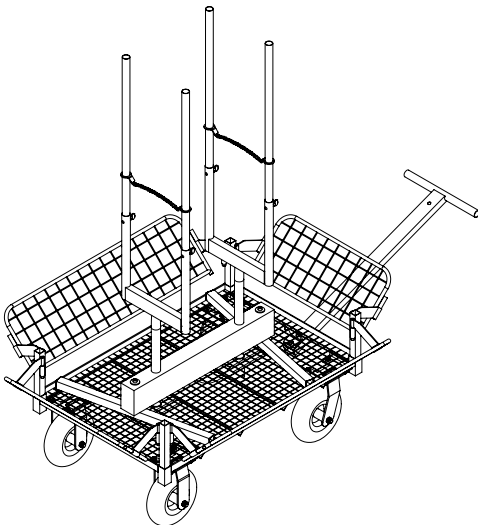



## Bulk Log Stand “U Sections”

A pair of “U Sections” from either a Bulk Log Stand 2 or 4 can be fitted directly into the cart.

Insert an M6 bolt minimum length 40 mm (not supplied) through the hole in the bottom of each of the two tubes below the bed of the cart and secure with a nut (not supplied).

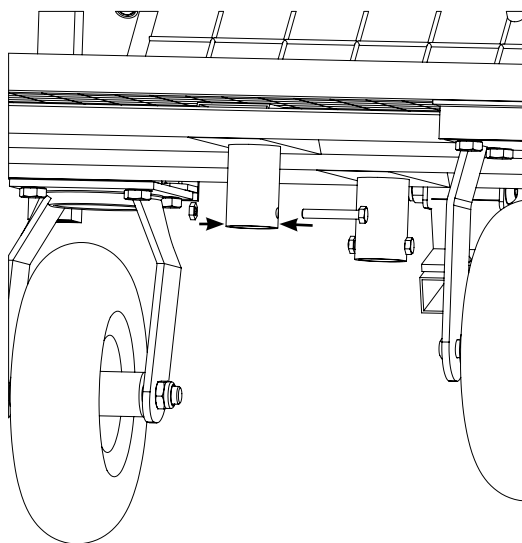

Insert the central support post of a “U Section” into each of the tubes so that it rests on the bolt inserted through the bottom.

In order to ensure stability when cutting logs, the tubes are a tight fit therefore it may help to insert the tubes fully, if they are lubricated with grease or oil.

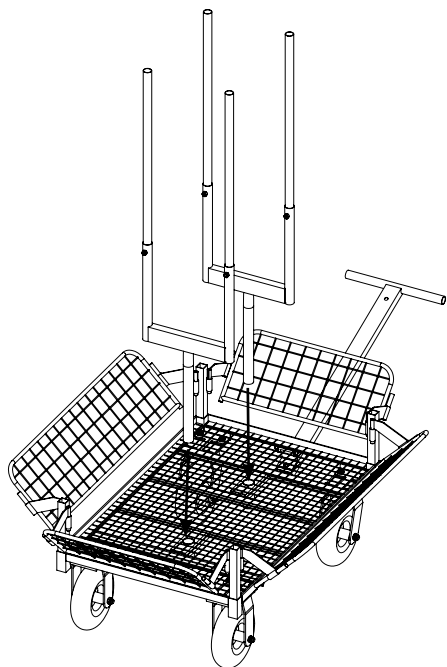



## IMPORTANT SAFETY INFORMATION

Please read these instructions carefully. Note the safe operational requirements, warnings & cautions. Use the Heavy Duty Cart correctly and with care for the purpose for which it is intended. Failure to do so may cause damage and/or personal injury and will invalidate the warranty. Please keep these instructions safe for future use.

Before using the cart always check that all nuts and bolts are secure and that the sawhorse is not damaged.

If using the cart with a sawhorse, use the sawhorse and the cart are on firm level ground only. Do not use on sloping or uneven ground.

After securing a log in the sawhorse, check the stability and balance before starting to cut. The sawhorse must not be able to tilt.

Read and observe the operating instructions of the chainsaw you are using and wear all recommended safety gear. Always wear safety shoes or boots in case a log is accidentally dropped on your feet.

Only cut with the bottom of the chainsaw bar as the log may otherwise shift away from the rotating chain, become unstable and increase the risk of personal injury.



## Warranty

This Heavy Duty Cart carries a one (1) year limited warranty against defects in workmanship and materials. Should this Heavy Duty Cart become defective within the stated warranty period, return it to the store with proof of purchase, and it will be replaced or repaired free of charge.

Should this product become defective, contact the store where it was purchased and either replacement parts will be issued, it will be repaired or it will be replaced free of charge.

**IMPORTANT: NO RESPONSIBILITY IS ACCEPTED FOR  
INCORRECT USE OF THIS PRODUCT.**



**WWW.FOREST-MASTER.COM**

**NOTE:** It is our policy to continually improve products and as such we reserve the right to alter data, specifications and component parts without prior notice.

Manufactured under license for Forest Master Limited.

Registered Office:

Forest Master Ltd, Industry Road, Heaton, Newcastle Upon Tyne,  
NE6 5XB, United Kingdom.

Tel: +44 191 2966939

email: [info@forest-master.com](mailto:info@forest-master.com) - web: [www.forest-master.com](http://www.forest-master.com)



[WWW.FOREST-MASTER.COM](http://WWW.FOREST-MASTER.COM)

---



[WWW.FOREST-MASTER.COM](http://WWW.FOREST-MASTER.COM)

---



[WWW.FOREST-MASTER.COM](http://WWW.FOREST-MASTER.COM)

---