



TRAY AND CAGE ASSEMBLY

ATTACH THE LOG TRAY AND CAGE

The tray and cage are only necessary to comply with CE Approval and health and safety at work legislation in the European Union. Outside of the European Union the individual user can choose to not use either or just use the tray. If you have purchased a stand for your log splitter, you may find it easier to fit the stand before fitting the tray and cage.

The tray & cage package contains

- 1 x Tray
- 2 x Tray Angle Bars
- 6 x Cage panels
- 25 x M6x12 Button Head Bolts
- 35 x M6 Nyloc Nuts
- 11 x M8x16 Cap Head Bolts
- 9 x M8x20 Cap Head Bolts
- 9 x M8 nyloc Nut
- 69 x M6 Thin Flat Washers
- 17 x M8 Flat Washers

Attach the two angle bars to the outside of the log splitter rails using 8 M8x20 cap head bolts, 16 M8 flat washers and 8 M8 nuts. The log rails are symmetrical so will fit on either side. No bolt is fitted through the front slot in each angle bar.

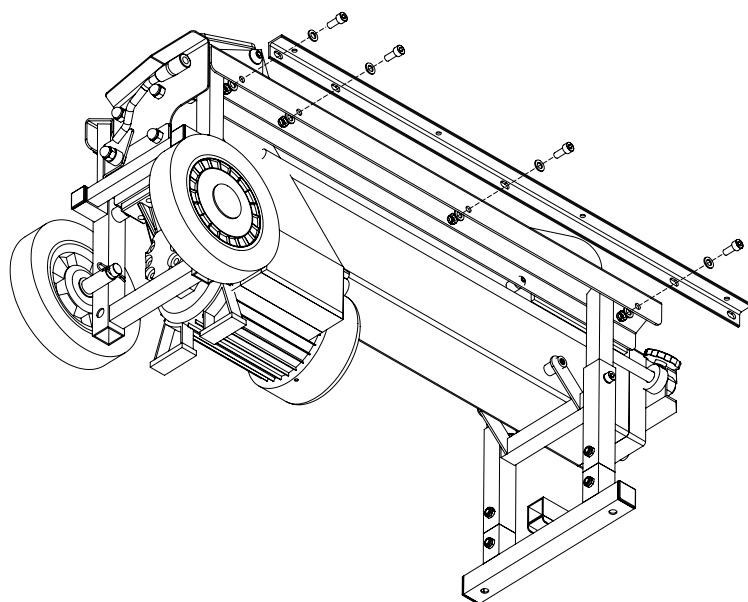
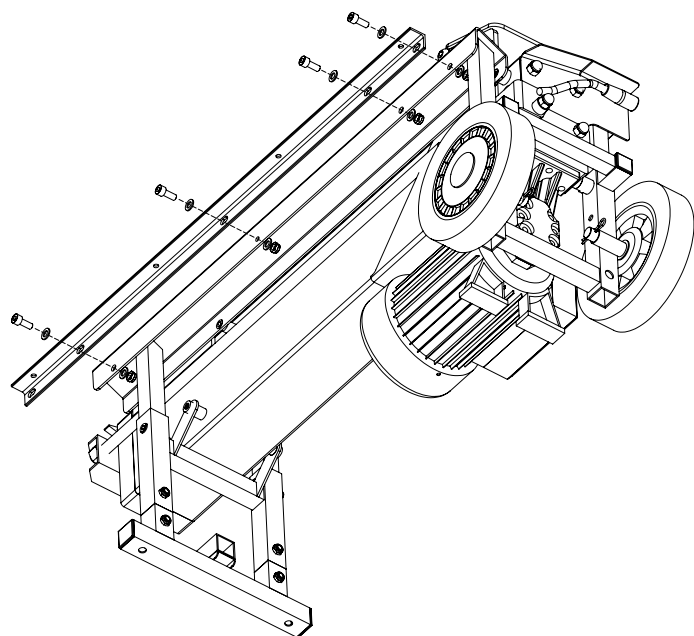



TRAY AND CAGE ASSEMBLY

Attach the tray to the angle bars using 8 M6x16 cap head bolts, 16 M6 flat washers (one above the tray and one under the angle bar for each bolt) and 8 M6 nyloc nuts.

The slots for the bolts in the tray allow it to be moved left and right to get it centrally positioned.

Once it is positioned correctly tighten the nuts.

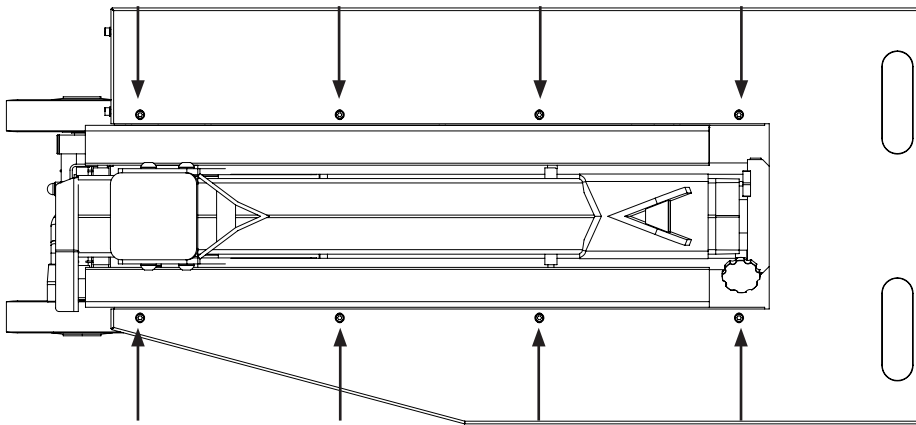
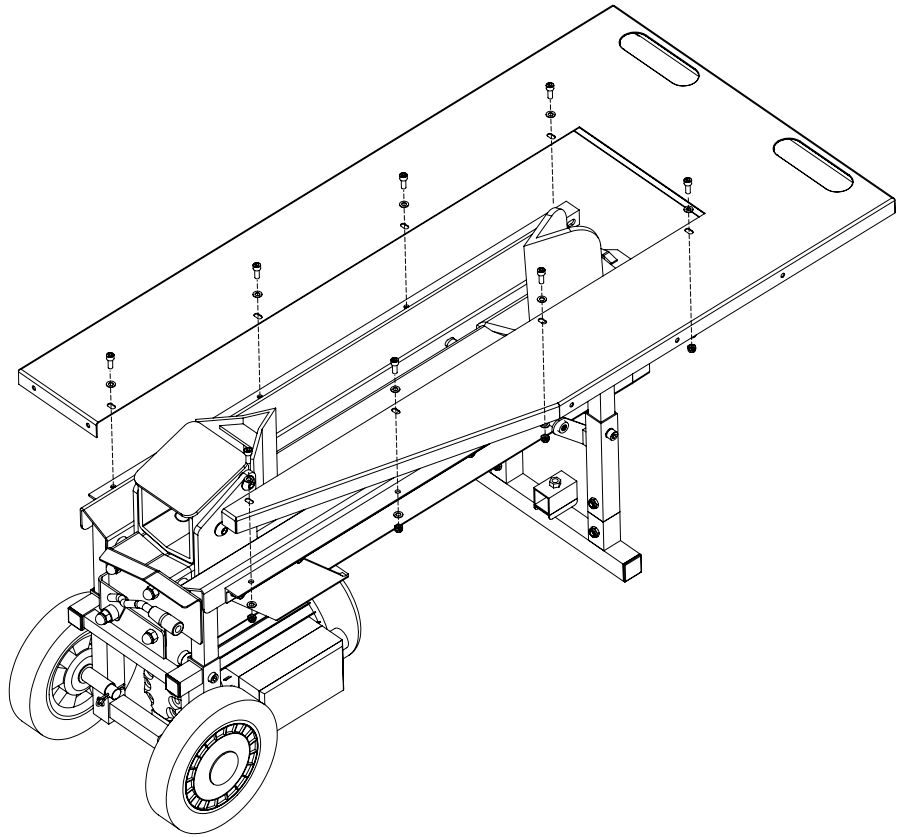



TRAY AND CAGE ASSEMBLY

Fasten the rear cage panel to the left hand rear flange of the tray, using 2 M6x12 cap head bolts, 4 M6 thin washers (one under the bolt head and one under the nut) and 2 M6 nyloc nuts. Do not fully tighten any cage bolts until assembly is complete.

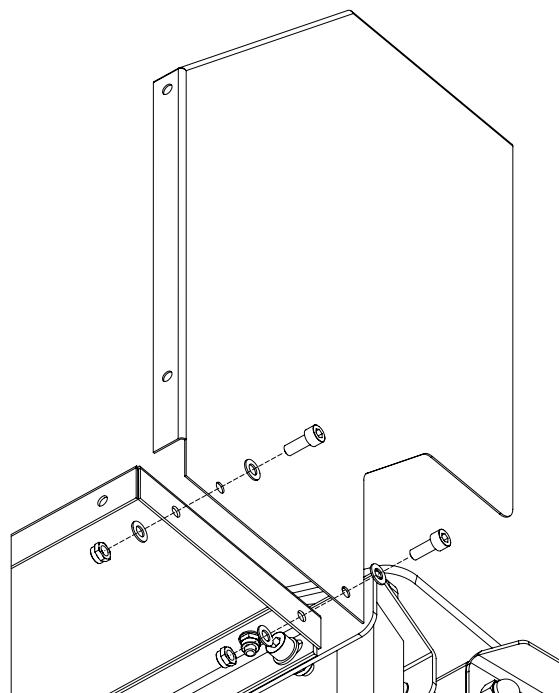

Do not add a nut and bolt at this stage.

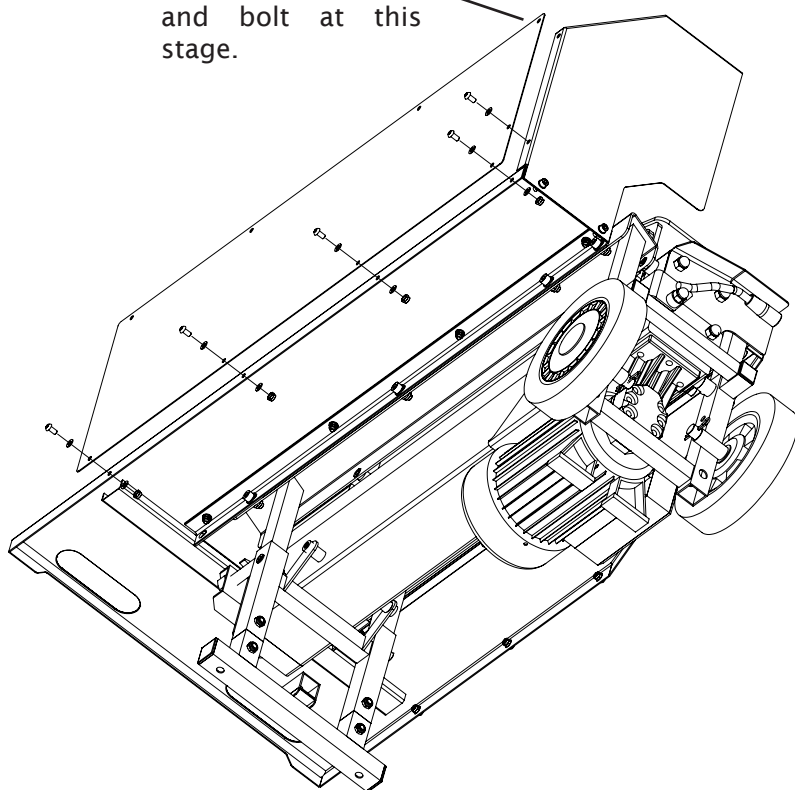

Attach the longer of the two plain cage panels to the left side of the tray and the rear cage panel. The bottom rear corner has two closely spaced holes, the top rear corner has a single hole approximately 10mm from the rear edge. Do not fasten the top rear corner at this stage.

Use 5 M6x12 button head bolts, 10 M6 flat washers (1 under each bolt head and 1 under each nut) and 5 M6 nyloc nuts. Leave all nuts and bolts finger tight until the last step, this makes it easier to adjust the cage.

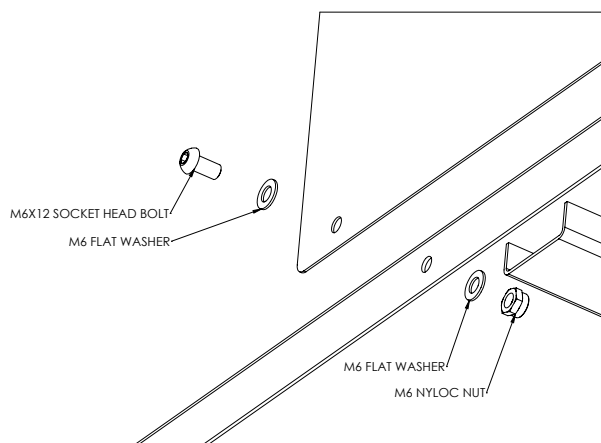



TRAY AND CAGE ASSEMBLY

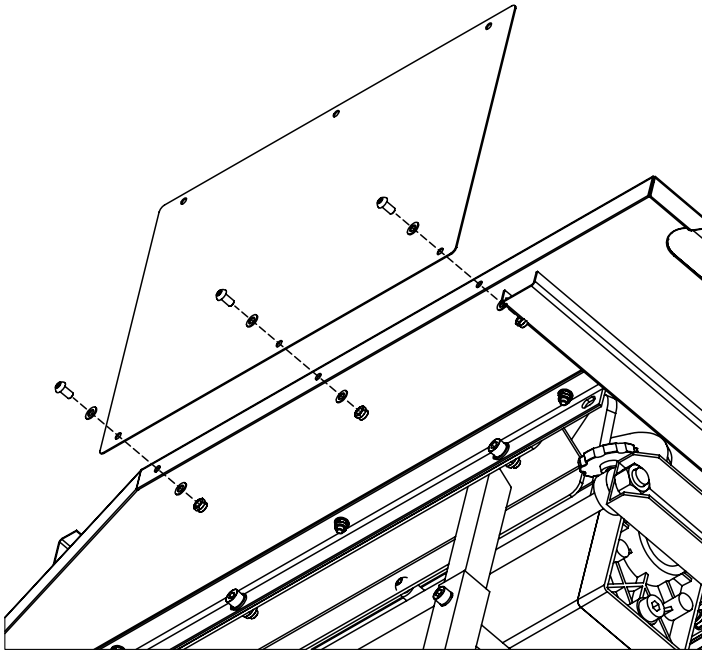

Attach the shorter of the two plain cage panels to the right side of the tray. For the orientation of the panel see the diagram below.

Use 3 M6x12 button head bolts, 6 M6 flat washers (1 under each bolt head and 1 under each nut) and 3 M6 nyloc nuts.

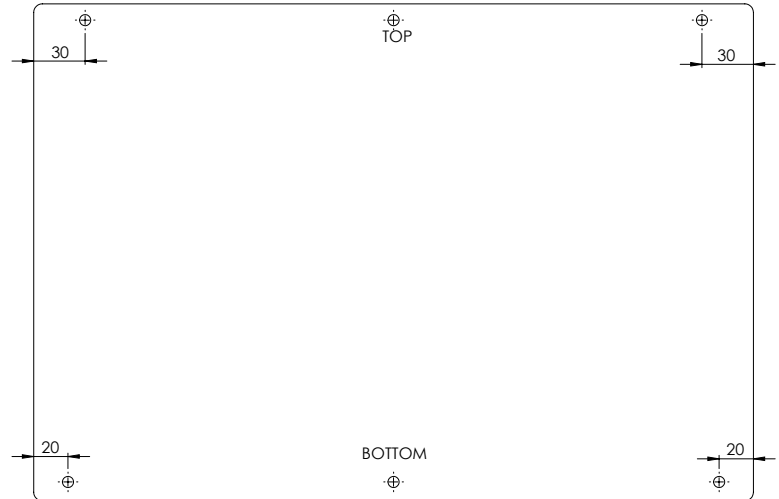

Attach the two flanged panels to the flat top panel, note that the flanges on the angled panels go on top of the top panel. Use M6x12 button head bolts, M6 flat washers either side and M6 nyloc nuts.

Do not join the longer angled panel to the top panel at it's rear corner at this stage. This corner is secured to the back panel in the next step.

For the correct orientation of the panels see the diagram on the next page.

Do not bolt this corner

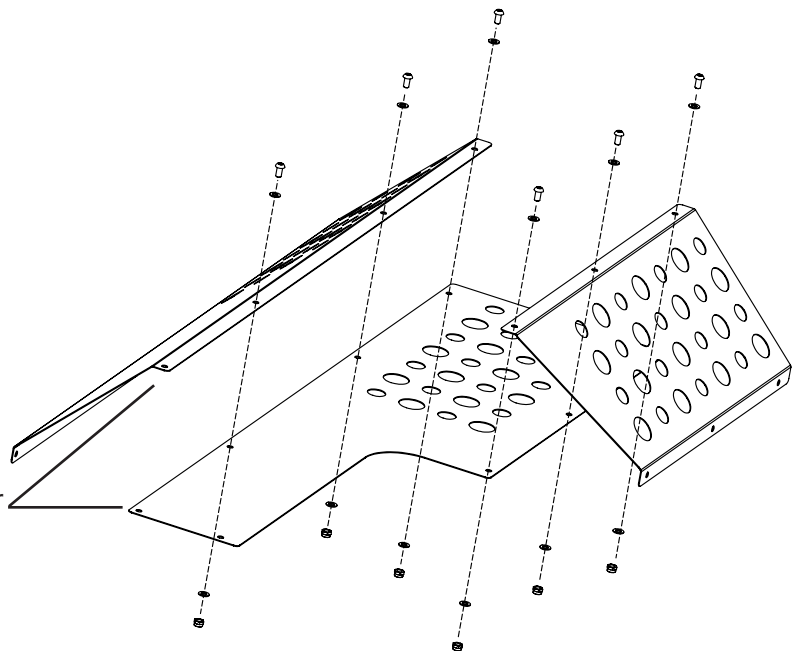



TRAY AND CAGE ASSEMBLY

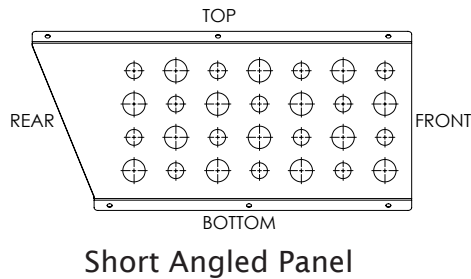
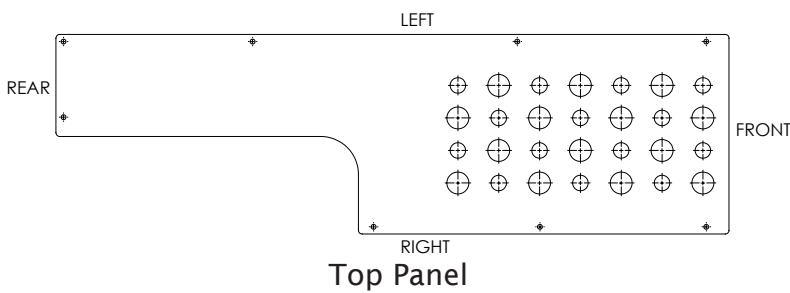
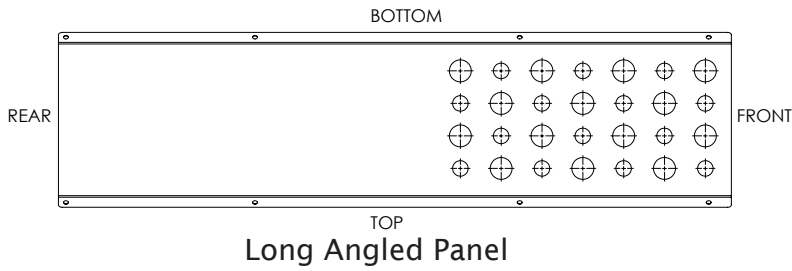

Fasten the assembled top section to the side panels and the rear panel using 10 M6x12 button head bolts, 20 M6 flat washers one either side of the panels for each bolts and an 10 M6 nyloc nut.

Note that the flanges of the angled panels go outside of the plain side panels.

You should now fully tighten all nuts and bolts for the cage and tray.

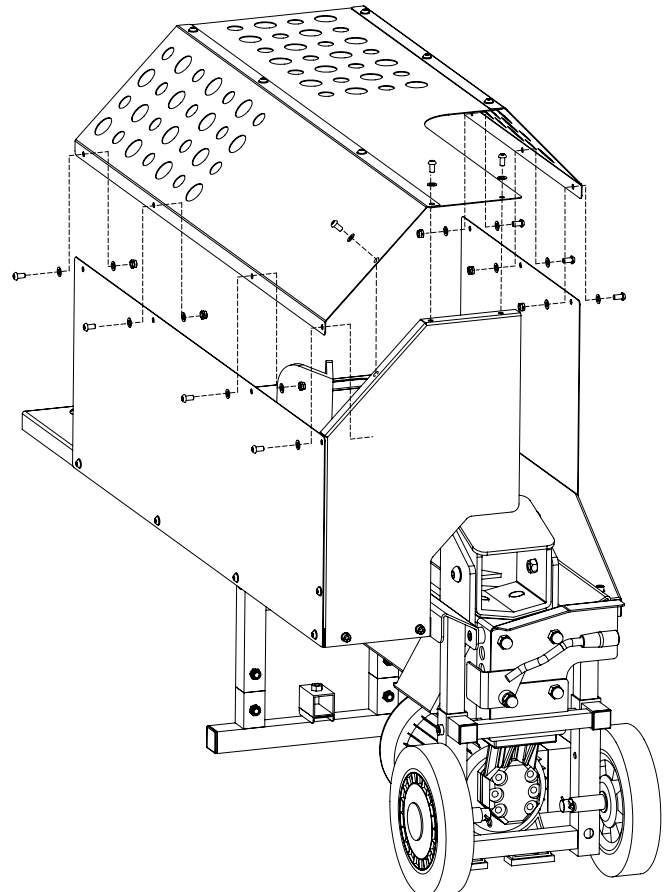



TRAY AND CAGE ASSEMBLY

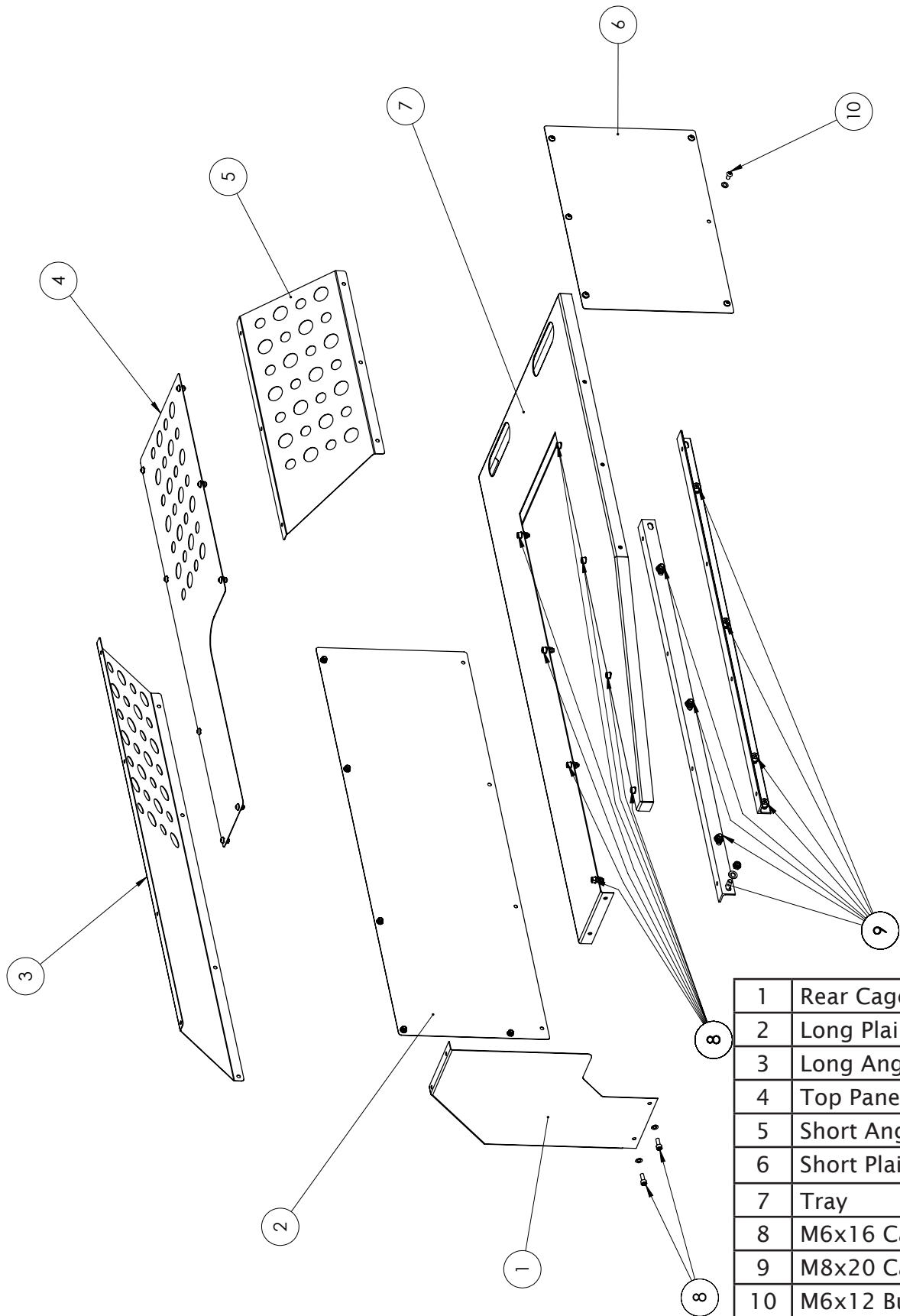

1	Rear Cage Panel	1
2	Long Plain Panel	1
3	Long Angled Panel	1
4	Top Panel	1
5	Short Angled Panel	1
6	Short Plain Panel	1
7	Tray	1
8	M6x16 Cap Head Bolts	8
9	M8x20 Cap Head Bolts	8
10	M6x12 Button Head Bolts Used for all cage bolts	24



TRAY AND CAGE ASSEMBLY

Safety

The tray and safety cage are designed to be used only with log splitters that are two handed operation. They must not be fitted to log splitters that can be operated one handed.

NEVER attempt place a hand or hands in the cage when it is operation.

NEVER attempt to place logs in the cage or remove them from within the cage when it is in operation.

NEVER allow a second person to assist in placing logs in or removing logs from within the cage whether it is in operation or not.

Before using the log splitter, check all bolts securing the panels of the cage together, the bolts that secure the cage to the tray and the bolts that secure the tray to the log splitter to ensure they are secure.

DO NOT place fingers or other objects through the holes in the top and angled panels, these holes are only to allow you to view the log.

DO NOT attempt to split a log greater than 400mm high as this may result in damage to the cage.

DO NOT attempt to load logs onto the log splitter through the front (fixed blade) opening.

ALWAYS load logs through the right hand rear opening.

DO NOT leave split logs lying inside the cage when splitting a subsequent log as these may be forced against the cage and damage it.

Specification

Length	1075 mm
Width	550 mm
Overall height	430 mm
Maximum log diameter	400 mm