



WWW.FOREST-MASTER.COM

FM3-LP

LOG LIFTER TREE PUSH User Manual

SAFETY AND OPERATION INSTRUCTIONS



IMPORTANT: READ SAFETY RULES AND INSTRUCTIONS CAREFULLY BEFORE OPERATING EQUIPMENT

TABLE OF CONTENTS

PART A: General Safety Rules.....3

PART B: Know your Log Lifter Tree Push.....4

PART C: Operating the Log Lifter Tree Push.....6

PART D: Maintaining the Log Lifter Tree Push.....8

PART E: Parts List.....9

Conventions used in this manual

 **WARNING**

This indicates a harzadous situation, which, if not avoided, could result in death or serious injury.

 **CAUTION**

This indicates a harzadous situation, which, if not avoided, could result in minor or moderate injury.

 **NOTICE**

This information is important in proper use of your machine. Failure to follow this instruction could result in damage to your machine or property.

Additional Information and Potential Changes

We reserve the right to discontinue, change, and improve our products at any time without notice or obligation to the purchaser. The descriptions and specifications contained in this manual were in effect at printing. Equipment described within this manual may be optional. Some illustrations may not be applicable to your machine.

Safety labels found on your unit.

WARNING



All users must read and understand the instructions and safety warnings in this manual and the safety labels placed on the product before using the FM3-LP. Each user must use the tool safely and maintain it properly.

If any users have any questions about using this FM3-LP, please see back of manual for contact information.



DO NOT USE FM3-LP TO SUPPORT OR STABILIZE A LOAD. Using the tool to support or stabilize a load may result in unexpected movements causing serious injury of being crushed and death. Always make sure no parts of the body are directly placed underneath a raised load.



When used as a Tree Push, always ensure the FM3-LP is used in line with the felling path. Always stand behind the Pusher and tree at all times especially when sawing down a tree.



As a Log Lifter, it has a maximum loading capacity of 3 tons. Never use this tool to lift more than the maximum load as this may weaken the tool causing it to either bend or snap which will result in serious injuries or death.

Unexpected movements in the FM3-LP may cause serious injuries or death, always keep head away from the handle at all times and ensure to clip the handle at the "UP" position when not in use.

Important! During lifting and lowering loads, the weight of the load pushes up against the FM3-LP's handle. If your hand should slip off the handle, or if the handle is horizontal when you move the reversing latch, it may move up very quickly.

NOTICE



The FM3-LP, while standing vertically and unsupported, may tip over and cause serious injuries or death. Always support the tool or lay it on its side when not in use.

This FM3-LP will NOT operate safely without proper lubrication. Using the tool without proper lubrication will result in poor performance and damage its parts. The FM3-LP is NOT self-lubricating, inspect the jack before use and lubricate when necessary.

PART A: General Safety Rules



- This FM3-LP will not stabilize the load. The load must be securely spiked and blocked (stabilized) to prevent it from falling.
- Do not use Lifter to support a load. Never get under a raised load.
- Always clip the handle against the steel standard (bar) before moving the reversing latch.
- Always keep all body parts clear of the handle's range of motion. If your hands slip off the handle, or if the handle is horizontal when the reversing latch is moved down, it may move up very quickly posing severe striking danger.
- Do not use this FM3-LP on vehicles. The vehicle could slip off the Lifter and fall, which could result in serious injury or death.
- The FM3-LP must be bearing weight to lower step-by-step. Otherwise, the lifting mechanism will slide down to the base plate, "dropping" your load.
- This FM3-LP is not self-lubricating and will not safely operate without proper lubrication. Always be sure all working parts and edges of the standard steel bar are well lubricated, free of rust and debris. Never attempt to use this FM3-LP if it is missing any part(s) or if any part(s) is broken, damaged, or malfunctioning in any way.

**MAX LOAD:
3000 KG**



INSTRUCTIONS

- Lubricate all working parts and edges of the standard steel bar. They should be free of rust, debris or other contaminants before using the FM3-LP.
- Securely place the Lifter's base plate on a level, firm, dry surface with the standard steel bar pointing straight up. Lift the reversing latch until it locks in the UP position.
- Grab the handle or the handle socket and raise the lifting mechanism until the nose is just above the halfway line of the diameter the load. Securely spike the nose into the load.
- Grasp the handle firmly with both hands. Carefully pump the handle up and down to raise the load.
- The load will be raised on each DOWN stroke of the handle.
- When not operating the handle, it should be clipped in the full upright position parallel to the standard steel bar
- With the handle clipped in the full upright position, move the reversing latch to the down position.
- Grasp the handle firmly with both hands. Carefully pump the handle up and down to begin lowering the load.
- The load will be lowered on each UP stroke of the handle.

PART B: Know your Log Lifter Tree Push



Product Information

The Forest Master **Log Lifter** is a versatile tool for tree surgeon or forestry professionals. The FM3-LP can be used for lifting heavy cut logs off the ground. This Lifter unlike regular products is capable of lifting up to 3 tons in weight. It can be put to other applications such as uprooting stump roots.

This dual functional machine could also be used as the Forest Master **Tree Push**. Felling trees indeed over the years has proven to be a dangerous operation as shown on several reports on occupational hazards in the forestry sector. The Tree Push is intended to provide safety for it's users during tree felling operations by ensuring that the tree falls in the intended direction. So for even local tree fellers or customers working at home, this tool makes the working site a safer environment. You should of course have felling wedges handy but in the likely scenario that you are not familiar power tools such as chainsaws or have trees standing out of place and likely to fall on something valuable, the Tree Push ensures full control of the falling direction. All you need to do is press the head of the pusher against the tree, facing the desired falling direction.

Technical Specifications

Log Lifter & Pusher

Max Load: 3 Tonne (3000kg)

Max height of Lift: 1000mm

Max height of Push: 2300mm

Dimensions HxWxL: 1370 x 150 x 250mm

Net Weight: 13kg

PART C: Operating the Log Lifter Tree Push

Part I: RAISING A LOAD

Fig. 3

1. Make sure you have read and understood all safety precautions and instructions. Lift the reversing latch (20) to its "UP" position and ensure its locked in place. With the indentation in the latch firmly engaged in the notch on the reversing switch (18)(refer to fig. 1), Jack up the spike nose to be in line at desired point of lift. Insert the spike nose just above the half way line of the diameter of the load (see fig.3) and place the foot of the Lifter beneath the load on ground level.

2. Pull down firmly and evenly on the handle and observe the load rising. As the handle is pulled down, you would hear the climbing pin (15) click into place as it locks into a hole on the steel bar (3). At this point, relax the handle allowing the climbing pin to take the load. Raise the handle to the top of its stroke position, to put it to rest simply click the handle back in place with the holding pin.



Middle point of log

Safe region to insert spike nose

Too Far above balance point

Too Far below balance point

IMPORTANT



1. Do not use extensions on the handle.
2. Always keep a firm hold on the handle

Operating the Log Lifter Tree Push

Part II: LOWERING A LOAD

The lifter must be loaded with at least a minimum of 50kg (110lbs) to lower step by step, otherwise the lifting spike nose will drop.

Taking all the necessary precautions, take the load with the load with the lifter (i.e raise the load slightly off ground level) ensure the handle is in a FULLY UPRIGHT position, trip the reversing latch (20), so that is in the “DOWN” position, the indentation on the latch becomes disengaged from the notch on the reversing switch (see fig. 2). Keeping a firm grip on the handle, pump it as you would for “raising a load”.

IMPORTANT

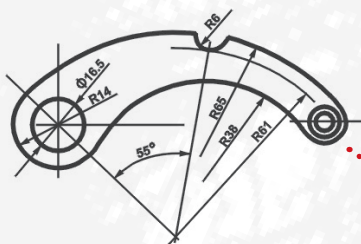

To lower a load

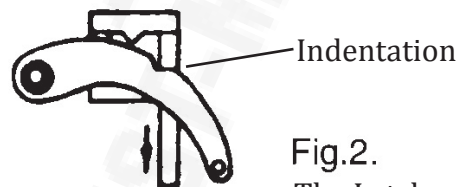
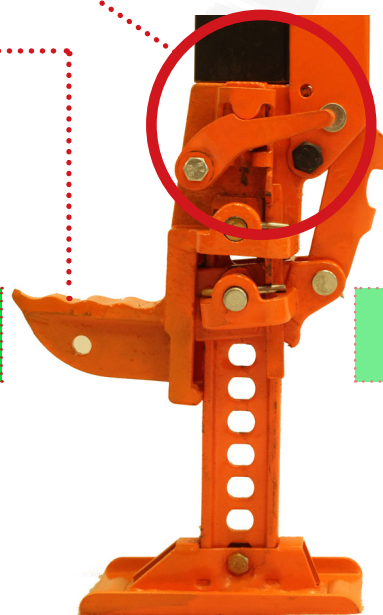
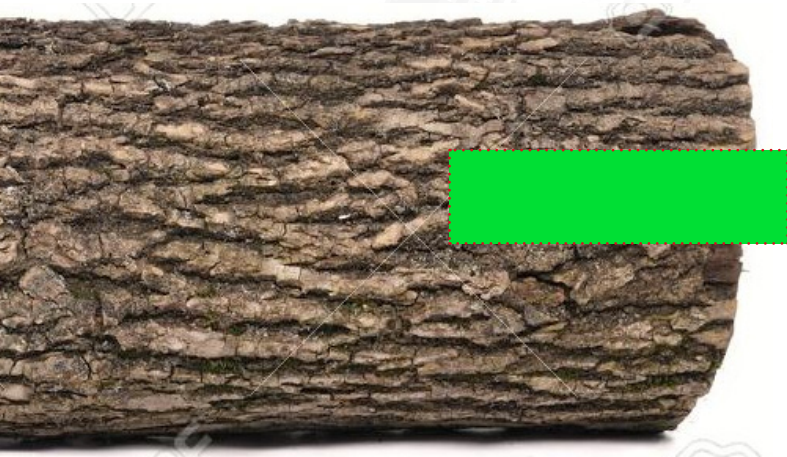

Fig.2.
The Latch

Spike Nose



**SPIKE NOSE GOES
INTO THIS REGION**

IN LOG OR LOAD

Operating the Log Lifter Tree Push

Part III: PUSHING A LOAD

Pushing a tree during a felling operation can be very hazardous. Please ensure to familiarize yourself with the safety instructions.

First after identifying the tree you desire to fell, ensure you check the surroundings of the tree to be felled. Identify a clear path of felling, a path free of obstacles and valuable property to avoid injuries or loss of personal belongings.

Facing the direction of the felling path, notch a small section into the tree (see fig. 4). Using the tool as a measure, the slit on the tree should appear just below the top of the teeth of the Tree Push about a few centimetres. This is where the teeth of the Push should be wedged when operating the tool (see fig 5).

Stand back about 70cm from the desired tree to be felled, facing the direction or path you have chosen to fell in. After making sure the path is clear, place the Tree Push against the tree at the pre-cut notch in the tree, at a 15 degree angle from ground level leaning towards the tree, with it's foot secured on the ground. Ensure the indentation on the latch is engaged and then begin to apply pressure on the handle by gradually stroking up and down as you would for raising a load.

As soon as the pusher becomes tightly wedged against the tree, ensure once more there are no obstacles between and underneath the pusher and the tree. If all clear, carry on in cutting down the tree rest assured the tree will fall in the intended directional path.

Fig. 4

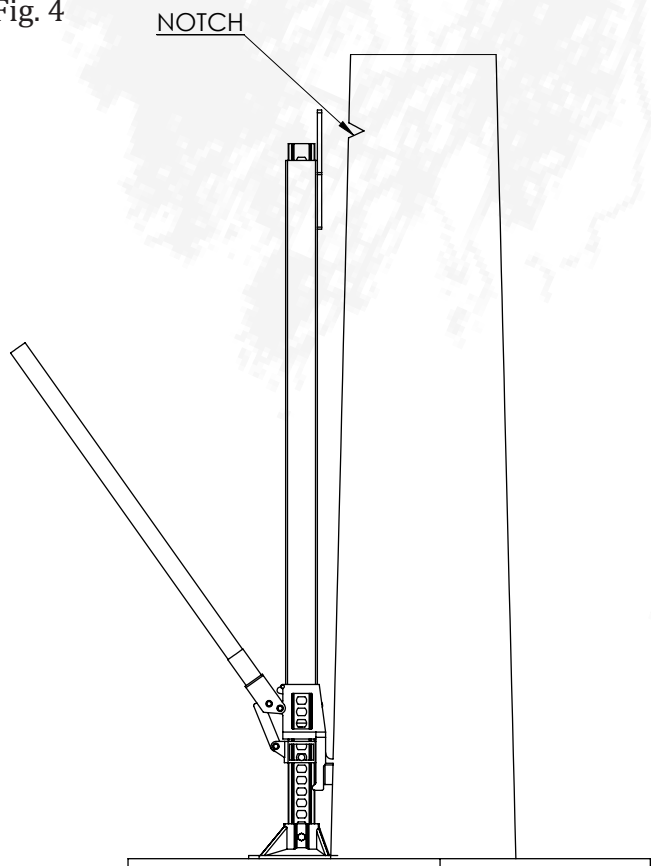
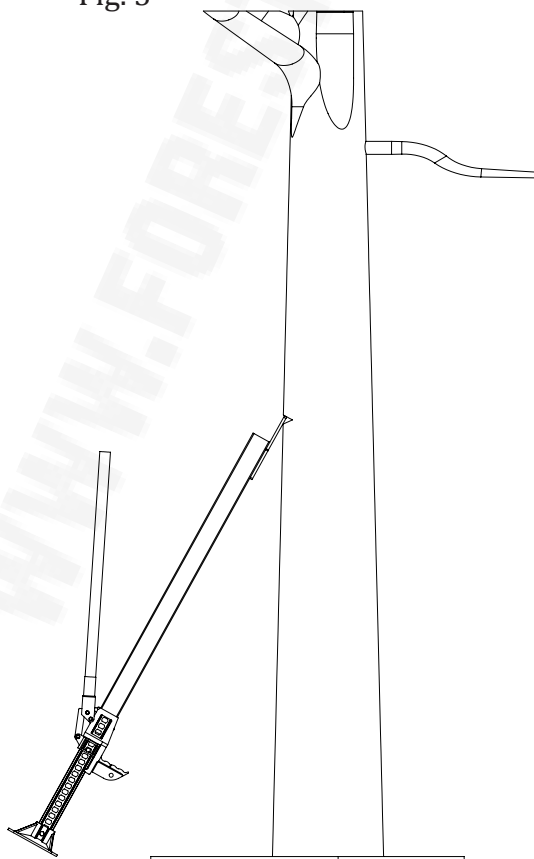

Fig. 5



PART D: Maintaining the Log Lifter Tree Push

If you use and maintain your FM3-LP properly, it will give you many years of service. Follow this maintenance instructions carefully to keep your tool in good working conditions. NEVER PERFORM MAINTENANCE ON FM3-LP WHILE IT IS UNDER LOAD.

CLEANING

If the moving spike of the FM3-LP or standard steel bar is clogged, use air pressure, water pressure or a stiff brush to clean. Use a non-flammable cleaning solvent or another good de-greaser to clean the tool. Remove any existing rust, preferably with a penetrating lubricant.

BINDING

If the climbing pins start to bind in the holes of the standard steel bar the jack will no operate properly and safely. Rusty climbing pins, dirt, or worn bar can be causes of binding.

Clean and lubricate the lifting mechanism as indicated in the lubricating section. Test the FM3-LP by lifting without load. If binding persists, contact our customer service for repairs or replacements. If the tool should bind while under a load, use the lifter with equal or larger load capacity to lower safely to the ground. After unbinding the tool clean, lubricate and test without load before resuming use.

STORING

1. Place handle in upright position and clip.
2. Raise the reversing latch until it locks in the UP position.
3. Store in the upright clipped position in a dry place, preferably indoors.

INSPECTION

You should inspect the FM3-LP for damage, wear, broken or missing parts (e.g climbing pins) and functionality before each use. Follow lubrication and storage instructions for optimum performance.

LUBRICATION

Using this FM3-LP without the proper lubrication will result in poor performance and damage to the tool. The tool is not self-lubricating; inspect the lifting mechism before use and lubricate when necessary. After cleaning, lubricate the FM3-LP using light penerating oil or a silcon or Teflon spray at the points marked 3, 9 and 19 on your part list (Standard Steel Bar railing, Small and Large Runners). (See part list)

PART E: Parts List

Part List:

1. Top Clamp-Clevis Bolt
2. Top Clamp-Clevis
3. Steel Standard (Bar)
4. Steel Handle W/Cotter Pin
5. Handle Socket
6. Pin
7. Hex Bolt
8. Connecting Rod
9. Small Runner
10. Screw Bolt
11. Base
12. Climbing Pin Spring (2 required)
13. Climbing Pin (2 required)
14. Cross Pin (2 required)
15. Reversing Switch Cam Bar
16. Cap Screw W/Washer
17. Reversing Latch
18. Reversing Switch Spring
19. Large Runner
20. Running Gear (assembled)

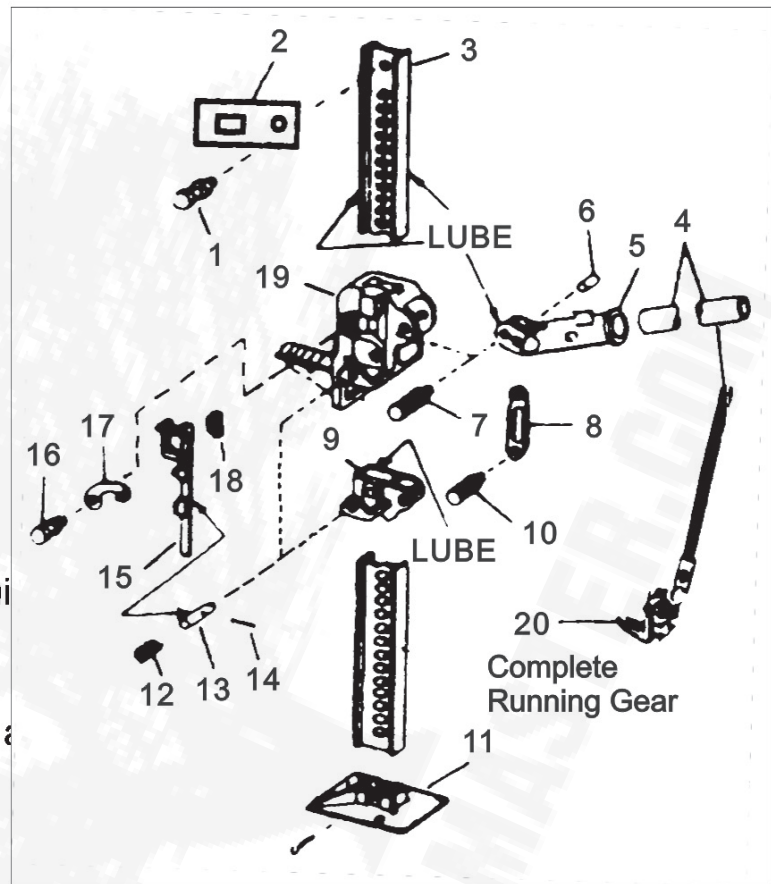

REPAIRS

If you need to repair your FM3-LP use only genuine Forest Master Parts supplied by us Forest Master. Using parts not supplied by us may make your tool unsafe for use and void your warranty.

CUSTOMER SERVICE

Industry Road
Heaton
Newcastle Upon Tyne
NE6 5XB
United Kingdom

Email: info@forest-master.com

Tel: +44 191 276 6553